

EcoSpec® Landscape Mini-Flood

Installation Guide

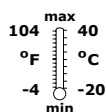

IP66



Included in Box

EcoSpec Mini-Flood
Installation Guide

Optional Items

Mounting Stake:
ES06-A-STK-UL-1
ES06-A-STK-CE-1

Additional Items Needed

Junction Box

Accessories

Barndoor: ES06-A-LC-BD-BK / WH
Hood: ES06-A-LC-HD-BK / WH

EcoSense Lighting Inc.

80 Broad Street
5th Floor
New York, NY 10004

www.ecosenselighting.com

Phone 212.228.8118
Fax 212.228.9113
Toll Free 855.632.6736
855.6.ECOSEN



Fixtures must be installed by a qualified electrician.

EcoSense Lighting, Inc. is not responsible if its fixtures are not installed in accordance with all national and local safety standards.

Plan the Installation

Verify the Electrical Plan

The fixtures must be mounted to a UL listed junction box or mounting stake.
Use DBR waterproof splice wire connectors.

Select Mounting Option

Choose the method best suited for the installation application.

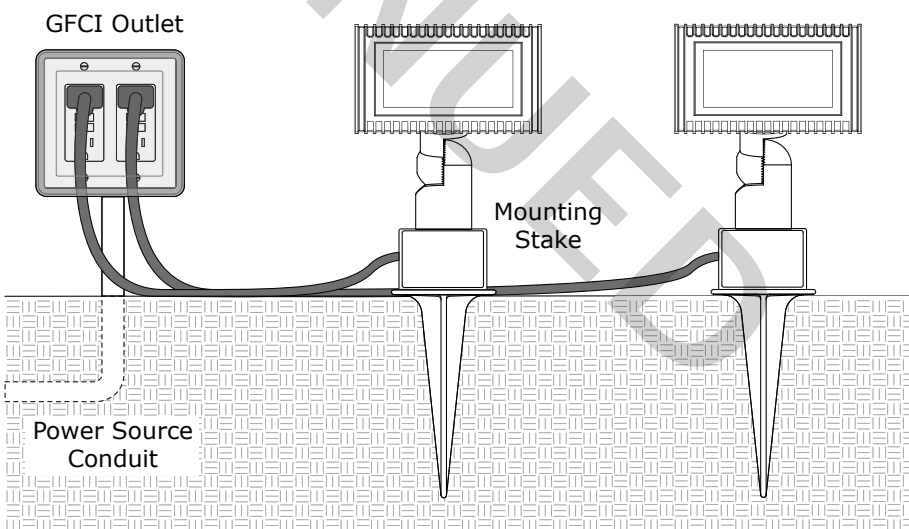
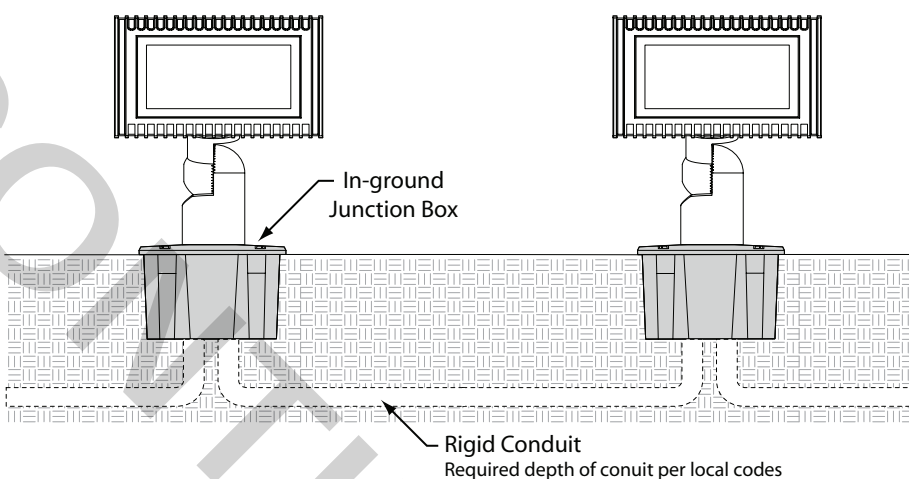

ECOSENSE®

Install the Fixtures

Installation Considerations

Power Consumption	12.7 watts
Operating Temperature	-4°F to 104°F (-20°C to 40°C)
Operating Voltage	100-120VAC, 220-240VAC, 50-60Hz
Weight	34.9 oz / 990 g
Dimensions	W 5.5" x H 3.5" x D 2.0" / (140 mm x 90 mm x 50 mm)



Ensure power is OFF

Connect Fixtures and Power

Using wire nuts, connect line, neutral, and ground within the stake connection box or the junction box.

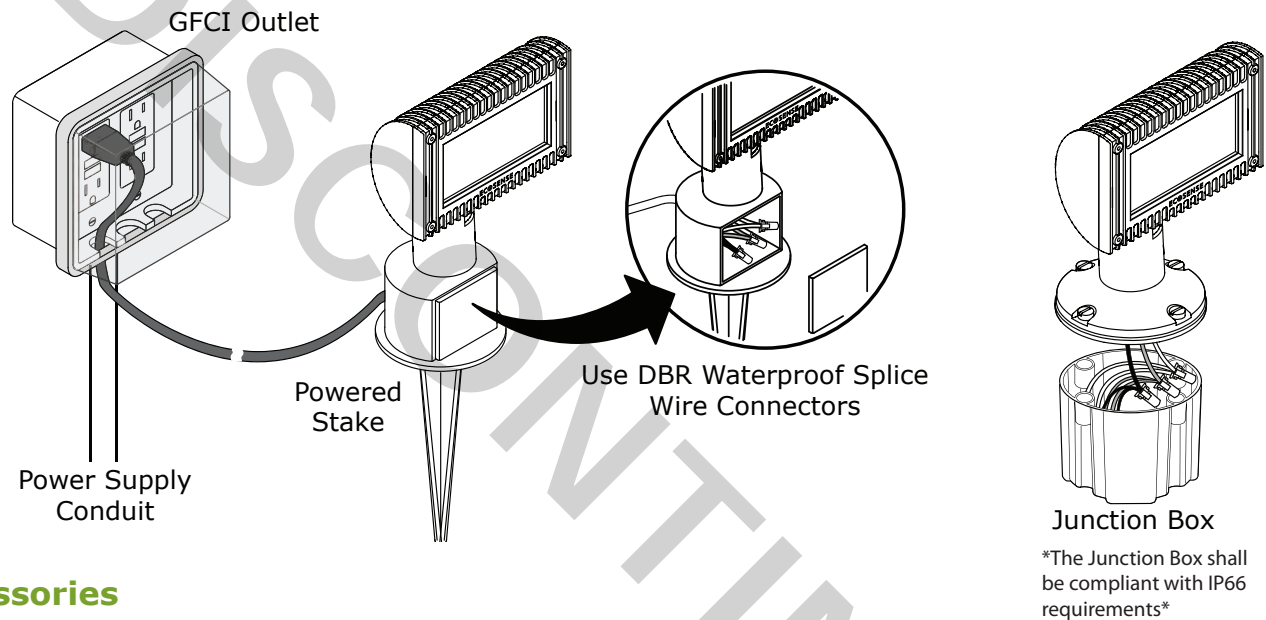

Accessories

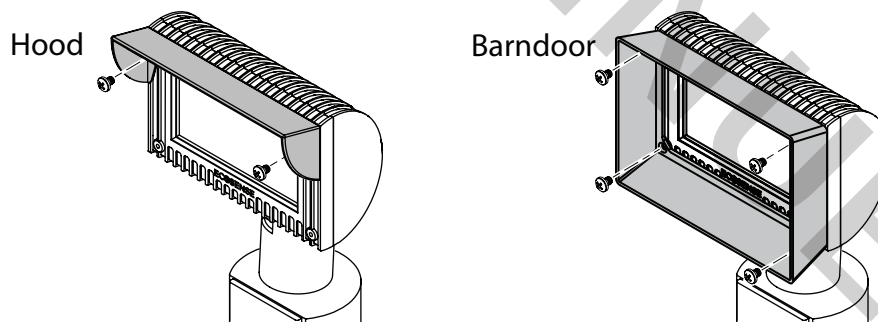

Read and understand the installation instructions before attempting to install or use the fixture.

Only use fixtures with voltage for which it is rated. Do not exceed the specified voltage and current input.

Do not use fixture if the housing, lens, or power cable are damaged.

Fixtures have line voltage risk of shock and no user serviceable parts. Do not attempt to open.

Do not hot swap. Ensure that power is off before connecting or disconnecting fixtures in the series.

Ensure that main power supply is off before installing or wiring a fixture.

LED Radiation. Do not view directly with optical instruments. Class 1M LED Product