

DATE	PROJECT	FIRM	TYPE
------	---------	------	------



Lamp Life
50,000 Hours

Beam Angle Options
25° / 36° / 60°

Color Rendering Index Options
80 CRI or 90 CRI

Dimming
Works with a variety of ELV dimmers

Finish
White or Black Powder Coat

Track System
EcoSense line voltage H-Track

Retrofit Compatible
Zinnia 1300i is compatible with standard line voltage H-Track
J-Track option available

Lamp
GE Infusion™ LED Module

Pan/Tilt Lock
Locks horizontal and vertical aiming position



FIELD-REPLACEABLE LED MODULE



SIDE VIEW



DATE	PROJECT	FIRM	TYPE
------	---------	------	------

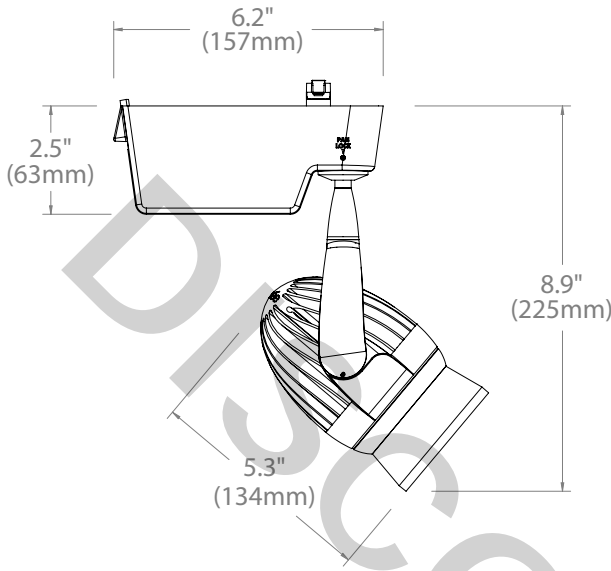

4000K / 80 CRI Infusion Module

LED lighting facts®
A Program of the U.S. DOE

Light Output (Lumens) **1376**
Watts **23.15**
Lumens per Watt (Efficacy) **59**

Color Accuracy
Color Rendering Index (CRI) **83**

Light Color
Correlated Color Temperature (CCT) **4097 (Bright White)**

LED Lumen Maintenance Projection
at 25,000 Hours at 25°C Ambient* **93.11%**

Warranty** **Yes**

All results, except LED Lumen Maintenance, are according to IESNA LM-79-2008: Approved Method for the Electrical and Photometric Testing of Solid-State Lighting. The U.S. Department of Energy (DOE) verifies product test data and results.

* Based on TM-21 projections for the light source.
** See www.lightingfacts.com/products for details.

2700k / 80 CRI

25° CBCP: 4,265		
Distance (feet)	FC*	Diameter (feet)
2	1,066	0.81
4	267	1.63
6	118	2.44
8	67	3.26
10	43	4.07
12	30	4.88

36° CBCP: 2,443		
Distance (feet)	FC*	Diameter (feet)
2	611	1.23
4	153	2.47
6	68	3.70
8	38	4.94
10	24	6.17
12	17	7.41

60° CBCP: 1,152		
Distance (feet)	FC*	Diameter (feet)
2	288	2.12
4	72	4.24
6	32	6.35
8	18	8.47
10	12	10.59
12	8	12.71

*Approximate foot candle values at center of beam

3000k / 80 CRI

25° CBCP: 4,739		
Distance (feet)	FC*	Diameter (feet)
2	1,185	0.81
4	296	1.63
6	132	2.44
8	74	3.26
10	47	4.07
12	33	4.88

36° CBCP: 2,714		
Distance (feet)	FC*	Diameter (feet)
2	679	1.23
4	170	2.47
6	75	3.70
8	42	4.94
10	27	6.17
12	19	7.41

60° CBCP: 1,280		
Distance (feet)	FC*	Diameter (feet)
2	320	2.12
4	80	4.24
6	36	6.35
8	20	8.47
10	13	10.59
12	9	12.71

4000k / 80 CRI

25° CBCP: 5,213		
Distance (feet)	FC*	Diameter (feet)
2	1,303	0.81
4	326	1.63
6	145	2.44
8	81	3.26
10	52	4.07
12	36	4.88

36° CBCP: 2,986		
Distance (feet)	FC*	Diameter (feet)
2	746	1.23
4	187	2.47
6	83	3.70
8	47	4.94
10	30	6.17
12	21	7.41

60° CBCP: 1,408		
Distance (feet)	FC*	Diameter (feet)
2	352	2.12
4	88	4.24
6	39	6.35
8	22	8.47
10	14	10.59
12	10	12.71

3000k / 90 CRI

25° CBCP: 4,028		
Distance (feet)	FC*	Diameter (feet)
2	1,007	0.81
4	252	1.63
6	112	2.44
8	63	3.26
10	40	4.07
12	28	4.88

36° CBCP: 2,307		
Distance (feet)	FC*	Diameter (feet)
2	577	1.23
4	144	2.47
6	64	3.70
8	36	4.94
10	23	6.17
12	16	7.41

60° CBCP: 1,088		
Distance (feet)	FC*	Diameter (feet)
2	272	2.12
4	68	4.24
6	30	6.35
8	17	8.47
10	11	10.59
12	8	12.71

ZINNIA 1300I ORDERING INFORMATION

ZIN	H1	13	HT	COLOR	BEAM	COLOR TEMP
				WH – White	25 – 25°	27 – 2700K
				BK – Black	36 – 36°	30 – 3000K
					60 – 60°	30/90 – 3000K/90CRI
						40 – 4000K

U.S. PATENT NO. D633,428
 AUSTRALIAN PATENT NO. 333962
 EU REGISTERED COMMUNITY DESIGN PATENT NO. 001244198-0001
 CANADIAN PATENT NO. 137836
 JAPANESE PATENT NO. 1424646
 CHINESE PATENT NO. ZL 201030603283.1
 OTHER PATENTS PENDING
 2015-04-22 106-0026

ZIN	H1	13	HT	COLOR	BEAM	COLOR TEMP
ZINNIA 1300I ORDERING CODE						