

| DATE | PROJECT | FIRM | TYPE |
|------|---------|------|------|
|------|---------|------|------|

SLIM COVE INT IS AN ENERGY EFFICIENT, HIGH OUTPUT, LOW PROFILE, SIMPLE INSTALLATION FIXTURE DESIGNED WITH LINE VOLTAGE IN-LINE CONNECTIONS. THE SLIM COVE LINE VOLTAGE ALSO CAN BE USED FOR PORTABLE LISTING APPLICATIONS WITH THE USE OF AN OPTIONAL CORD AND PLUG POWER CABLE.

FEATURES :

- ECONOMICAL
- LOW PROFILE
- HIGH EFFICACY
- SIMPLE INSTALLATION
- INTEGRAL DRIVER / AC POWER
- PORTABLE INSTALLATION AVAILABLE



| MODEL | LENGTH | COLOR | VOLTAGE | LENS |
|-------|---------------------------------|--|------------------|-----------------|
| SCIS | 06 - 6" 12 - 12" 48 - 48" | 27 - 2700K 30 - 3000K 35 - 3500K 40 - 4000K | 120 - 100-120VAC | CL - Clear Lens |

EXAMPLE: SCIS - 12 - 27 - 120 - CL

| PERFORMANCE | CCT(K) | OPTIC | LUMEN OUTPUT / LF | EFFICACY (lm/W) |
|-------------|--------|-----------|-------------------|-----------------|
| | 2700K | 120°x120° | 302 lm | 84lm/W |
| | 3000K | 120°x120° | 308 lm | 85lm/W |
| | 3500K | 120°x120° | 328 lm | 91lm/W |
| | 4000K | 120°x120° | 348 lm | 98lm/W |

COLOR RENDERING INDEX
COLOR CONSISTENCY
LUMEN DEPRECIATION / RATED LIFE

80+
2 STEP MACADAM ELLIPSE
L70 > 50,000 HOURS @ 25°C**

**Calculations for LED fixtures are based on measurements that comply with IES LM-80 testing procedures and IES TM-21 Calculator.

| ELECTRICAL | POWER CONSUMPTION | TYPICAL WATTAGE: 1.6W(6in) ; 3.5W(12in) ; 14W(48in) (THE TYPICAL INPUT POWER RANGE ALLOWS FOR A +/-10% VARIATION OF ALL COMPONENTS) MAXIMUM WATTAGE: 2W(6in) ; 4W(12in) ; 16W (48in) (ALL FIXTURES ARE LABELLED WITH MAXIMUM WATTAGE) |
|------------|-------------------------------|--|
| | MAX FIXTURE RUN LENGTH | 90ft (27m)^ |
| | OPERATING VOLTAGE | 100-120VAC, 50/60Hz |
| | DRIVER | INTEGRAL TO FIXTURE |
| | STARTUP TEMPERATURE | -4°F TO 122°F (-20°C TO 50°C) |
| | OPERATING TEMPERATURE | -4°F TO 122°F (-20°C TO 50°C) |
| | STORAGE TEMPERATURE | -40°F TO 176°F (-40°C TO 80°C) |
| | CONTROL | NOT DIMABLE. ON-OFF CONTROL ONLY |

EcoSense THD/Inrush Current/Power Factor Information: Please contact an EcoSense Lighting sales representative.
^Maximum run length is based on the measurements of 12" and 48" fixtures. Please contact an EcoSense Lighting representative for 6" fixture need.

ECOSENSE LIGHTING INC.
837 NORTH SPRING STREET
SUITE 103
LOS ANGELES, CA 90012

P • 310.496.6255
F • 310.496.6256
T • 855.632.6736
855.6.ECOSEN

SPECIFICATIONS SUBJECT TO CHANGE WITHOUT NOTICE. VISIT ECOSENSELIGHTING.COM FOR THE MOST CURRENT SPECIFICATIONS. FOR A LIST OF PATENTS VISIT ECOSENSELIGHTING.COM/IP-PORTFOLIO/
©2017 ECOSENSE LIGHTING INC. ALL RIGHTS RESERVED. ECOSENSE, THE ECOSENSE LOGO, TROV, TROY AND ECOSPEC ARE REGISTERED TRADEMARKS OF ECOSENSE LIGHTING INC.
RISE™, SLIM COVE™, FREEDOM TO CREATE™, MACRO™, FLIP-TO-FLAT™ ARE TRADEMARKS OF ECOSENSE LIGHTING INC.

ECOSENSELIGHTING.COM

1/3

| DATE | PROJECT | FIRM | TYPE |
|------|---------|------|------|
|------|---------|------|------|

| | | |
|-----------------|--|--|
| PHYSICAL | DIMENSIONS (WITH MOUNTING CLIP) (WITHOUT MOUNTING CLIP) | W 1.37" x H 0.93" x L 6"/12"/48"; (34.7mm x 23.6mm x 152.4/304.8mm/1,219.2mm) W 0.91" x H 0.91" x L 6"/12"/48"; (23mm x 23mm x 152.4/304.8mm/1,219.2mm) |
| | HOUSING / LENS | POLYCARBONATE |
| | WEIGHT | 0.13lbs / 0.06kg (6in) ; 0.24lbs / 0.11kg (1ft) ; 0.92lbs / 0.415kg (4ft) |
| | CONNECTORS | INTEGRAL MALE / FEMALE 2 PIN CONNECTORS |
| | ENVIRONMENT | INDOOR; ETL CERTIFIED FOR DRY/DAMP LOCATIONS |
| | BEAM ANGLE | CLEAR LENS: 120° x 120°, FROSTED LENS ACCESSORY AVAILABLE |
| | MOUNTING OPTIONS: | INTEGRAL ADJUSTABLE |

RATING & CERTIFICATIONS ETL Certified to UL 1598 and UL 153
RoHS Compliant



LIMITED WARRANTY 5 Years

OPTIONAL ACCESSORIES

Wiring Options

Power Cables - 120V

| | |
|--|-----------------------|
| *Leader Cable, 10ft | INT2P-A-LDR-120-10 |
| *Leader Cable, Cord + Plug, 10ft | INT2P-A-LDR-CP-120-10 |
| Jumper Cable, 12in | INT2P-A-JMP-120-12 |
| Jumper Cable, 3in | INT2P-A-JMP-120-03 |

* One (1) Terminator included standard with each leader cable.

One Leader Cable is required per circuit / fixture run. Leader / Jumper cables are not rated for plenum applications.

Mounting Options

| | |
|--------------------------------|------------------|
| Adjustable Mounting Clip | SCI-A-MNT-ADJ |
| Mounting Track, 48in | SCI-A-MNT-TRK-48 |

Louver Options

| | |
|--------------------|--------------|
| Louver, 6in | SCI-A-LVR-06 |
| Louver, 12in | SCI-A-LVR-06 |

Accessory Options

| | |
|-----------------------------------|------------------|
| In-Line Switch, Cord + Plug | SCI-A-ILS-CP-120 |
| Switched Junction Box | SCI-A-SJB-120 |

One (1) Terminator included standard with each In-Line Switch and Switched Junction Box.

Snap on Frosted Lens Options

| | |
|--------------------------|---------------|
| Frosted Lens, 6in | SCI-A-FRLS-06 |
| Frosted Lens, 12in | SCI-A-FRLS-12 |
| Frosted Lens, 48in | SCI-A-FRLS-48 |

| DATE | PROJECT | FIRM | TYPE |
|------|---------|------|------|
|------|---------|------|------|

DIMENSIONS - ADJUSTABLE MOUNTING CLIP - DIRECT MOUNT

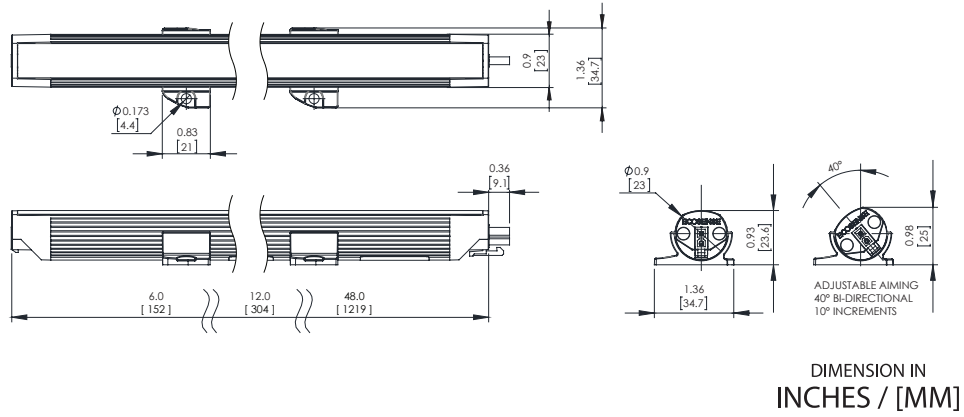

DIMENSIONS - ADJUSTABLE MOUNTING CLIP - DIRECT MOUNT WITH MOUNTING TRACK

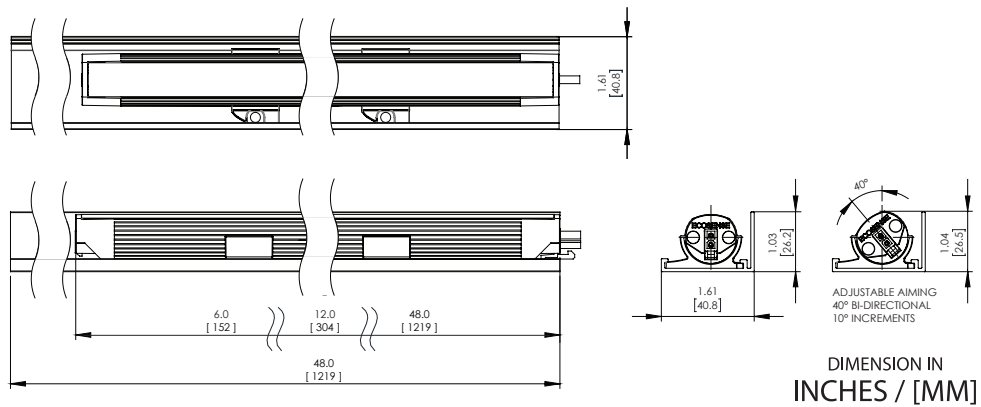

DISTRIBUTIONS
SCIS-XX-XX-120-CL
120° X 120°

